

E-142
Saml Richard's Land

B-215

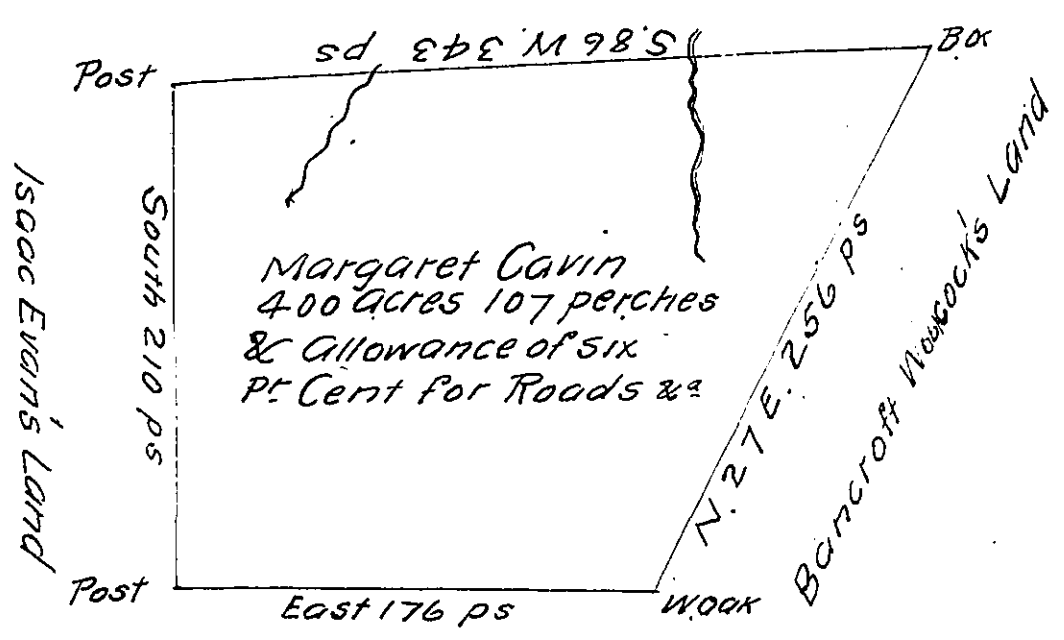

Hannah Cavins Land

A Draught of a Tract of Land, situate in Hopewell Township
in the County of Bedford, surveyed for Margaret Cavin -
May 10th 1794 in pursuance of a warrant granted Jan^y.
2nd 1794.

George Woods Jun^r D.S

To Daniel Brodhead Esq^t SG

IN TESTIMONY that the above is a copy of the original remaining on file in
the Department of Internal Affairs of Pennsylvania, made
conformably to an Act of Assembly approved the 16th day of
February, 1833, I have hereunto set my Hand and caused
the Seal of said Department to be affixed at Harrisburg,
this Fifteenth day of March 19/2

Henry Howard
Secretary of Internal Affairs.